

BRASS SIGHT GLASS

FEATURES

- This device should be installed on discharge side of drain valve (not for system static pressure)

TECHNICAL

- Code: *Please see below*
- Size Range: DN25 & DN50
- Ends: Female x Female thread
Male x Female thread
Female x Roll Grooved



Model # BH-19

DIMENSIONS

Code	Description	Length: A (mm)
FFS-SGB-25	DN25 Female x Female BSP	83
FFS-SGB-50	DN50 Female x Female BSP	85
FFS-SGB-50MF	DN50 Male x Female BSP	125
FFS-SGB-50GF	DN50 Grooved x Female BSP	125



MATERIALS

ITEM	DESCRIPTION	MATERIAL	QTY
1	Brass Body	Casting Brass B584	1
2	O-Ring	NBR	2
3	Clear Plate	Acrylic	2
4	Washer	Brass B16	2
5	Buckle	Stainless Steel A2	2

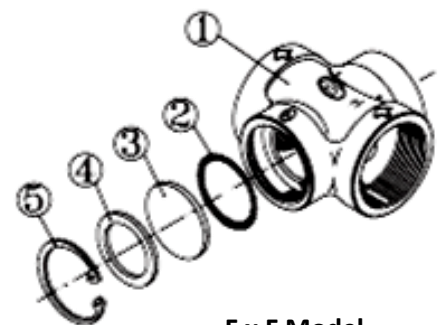

F x F Model

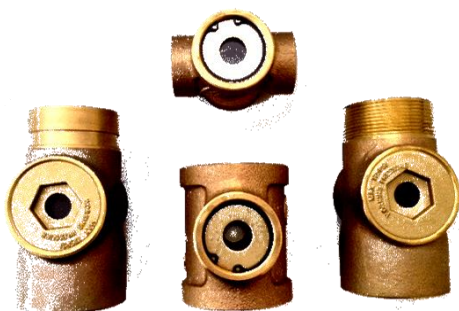

Left to Right: Grooved x Female, Female x Female, Male x Female